

# SIMPLEX

## TURN BUCKLE - EYE AND EYE

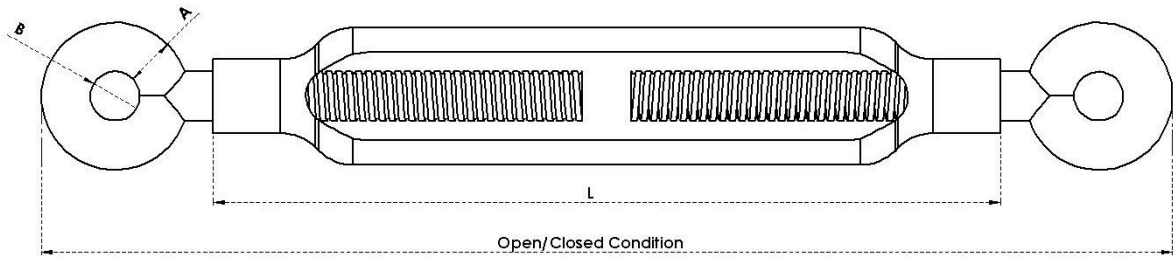

Size	Body Length (L)	Length		Eye Diameter (A)	Eye Hole Dia (B)	Weight/ No./ Kg	Capacity
		Open Condition	Closed Condition				
M6	105	250	180	7	10	0.01	
M8	125	290	200	9	13	0.15	150 kg
M10	160	370	255	10	15	0.35	300 kg
M12	205	475	330	12	19	0.7	450 kg
M16	260	610	410	15	23	1.3	750 kg
M20	310	700	470	15	30	2	1000 kg
M24	395	890	600	17	33	4	2000 kg
M30	435	960	650	26	42	6.45	3000 kg
M36	455	1020	710	32	48	11.4	4500 kg
M39	440	1020	710	30	49	11.45	5000 kg
M52	460	1190	900	40	75	24.65	10000 kg

# SIMPLEX

## TURN BUCKLE - EYE AND HOOK

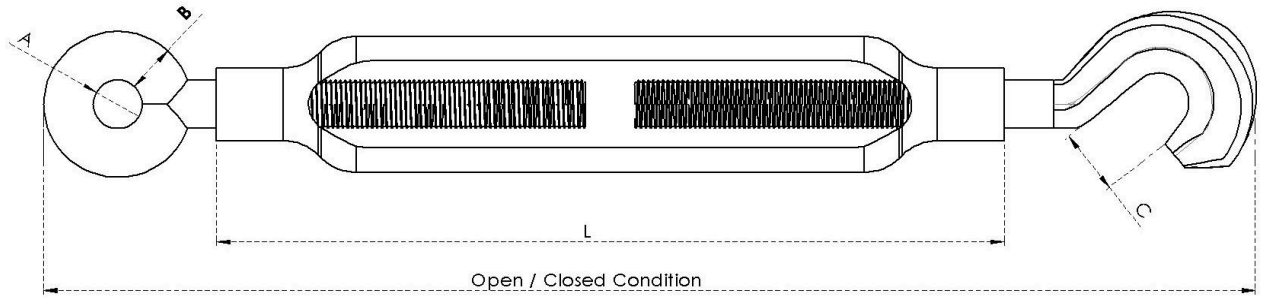

Size	Body Length (L)	Length		Eye Diameter (B)	Eye Hole Dia (A)	Hook Opening (C)	Weight/ No./ Kg	Capacity
		Open Condition	Closed Condition					
M8	125	290	200	9	13	10	0.15	150 kg
M10	160	390	270	10	15	12	0.4	300 kg
M12	205	470	320	12	19	13	6	450 kg
M16	260	570	380	15	23	20	1.2	750 kg
M20	310	740	500	15	30	27	2.1	1000 kg
M24	395	950	640	17	33	32	4.1	2000 kg
M30	435	1130	780	26	42	48	8.6	3000 kg
M39	440	1080	770	30	49	57	12.45	5000 kg

# SIMPLEX

## TURN BUCKLE - Jaw and Jaw

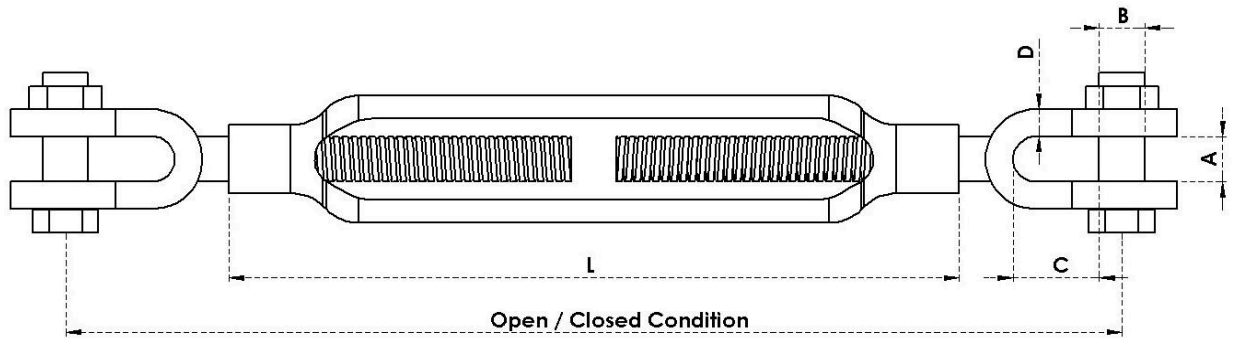

Size	Body Length	Length		Opening	Pin Diameter	Inner Length	Body Thickness	Weight
		Open Condition	Closed Condition					
	L			A	B	C	D	
M12	205	485	320	13	9	28	12	950 g
M16	250	610	415	18	11	42	12	1.65 kg
M20	305	730	490	22	15	50	14	2.85 kg
M24	400	940	615	22	18	53	16	5.1 kg
M30	442	945	680	32	18	60	15	7.250 kg
M39	460	1130	795	44	26	92	18	14.4 kg